

Imidaflea DOG

How to APPLY

Spot-on solution

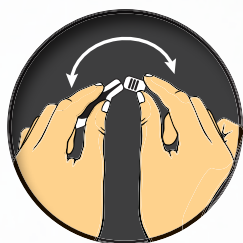

STEP 1

Hold the pipette upright.

Tap the narrow part of the pipette to make sure the contents are in the body of the pipette and snap back the tip.



STEP 2

Part your pet's coat at the base of their neck in front of the shoulder blades until the skin is visible.



STEP 3

Place the tip of the pipette on the skin and squeeze several times to empty its contents completely onto the skin in one spot.

